

4U Rackmount Chassis with eight 5.25" drive bays and one 3.5" drive bay, three hot-swappable fans and optional mini redundant power supply for RAID storage.

Retaining Bar
Supports 14 Slot Backplane or 12" x 13" Motherboard
Three Hot-Swappable Ball Bearing Fans

Eight 5.25" HDD Drawers with Lock for Maximum Access Security

One 3.5" Shock Resistant Drive

Supports PS/2 size and Mini Redundant Power Supply

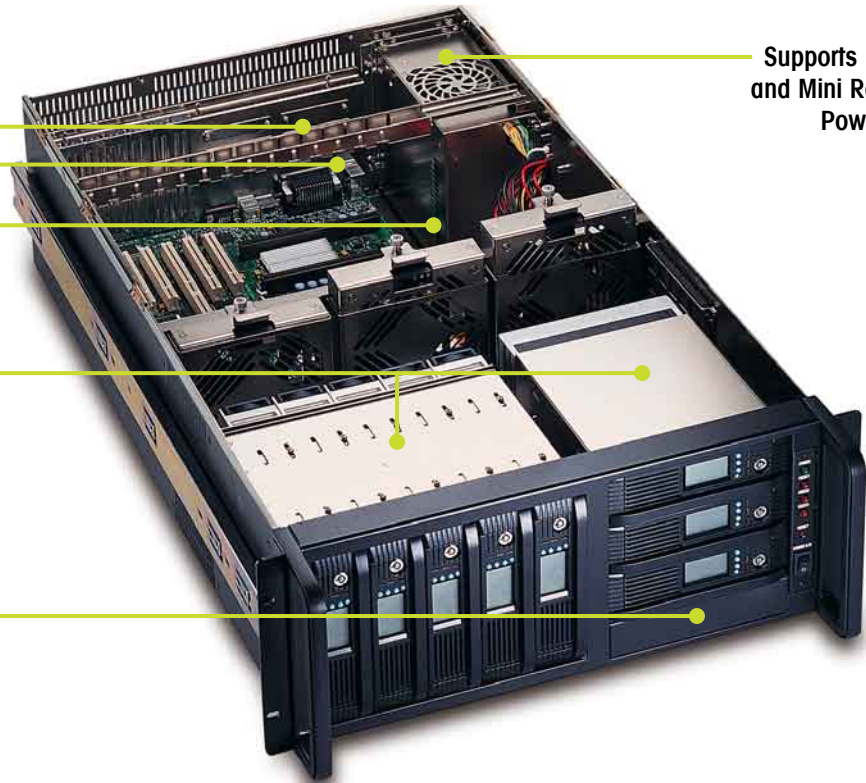

Introduction

If you are looking for a 4U industrial chassis that combines a server chassis with an optimum number of drive bays for RAID storage, there is no better choice than the RCK-409. It is easily configureable to support either an 12"x13" ATX motherboard or a 14-slot PICMG backplane and offers eight 5.25" drawers (lockable to prevent unauthorized meddling) for HDD, more than the number usually required for a RAID system. RCK-409 supports PS/2 size power supply and also mini-redundant power supply to complement fault tolerance of RAID. A retaining bar is included to hold expansion cards in place for those applications which encounter a high level of vibration. The RCK-409 combines a server system and data storage system, making it an ideal choice for file servers or other storage systems.

Features

- Standard 4U 19" Rackmount Chassis.
- Heavy Duty Steel with Ni plating.
- Eight HDD drawers with lock to protect drives.
- One 3.5" shock-resistant drive.
- Anti-Vibration Card Clamp.
- 12"x13" Motherboard or 14-slot Backplane Support.
- Supports PS/2 or mini-redundant power supply.

Contact Information

12F-3 No 77 Shin Tai Wu Road Sec 1
221 Hsi Chi, Taipei Hsien, Taiwan, ROC
Telephone: +886-2-2698-3280 / Fax: +886-2-2698-3304
Sales: sales@aicsys.com / Technical Support: support@aicsys.com

Technical Drawing

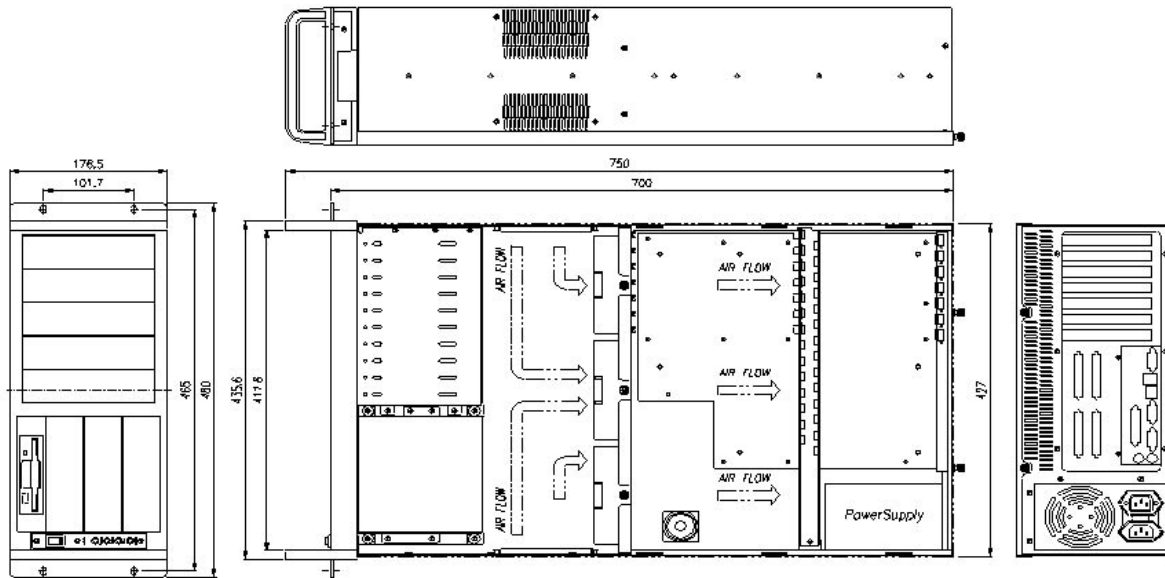

Construction

Heavy duty steel with Ni plating

Color

Black

Board Support

14 slot backplane or Motherboard 12"x13".

Drive Bays

Eight 5.25" + one 3.5" external drives.

Expansion

Depends on backplane or motherboard.

Power Supply

Supports PS/2 size and PS/2 size mini redundant power supply.

Cooling

Three 12 cm hot-swappable high speed ball bearing fans.

Keyboard/Mouse Ports

N/A

Switches

On/Off switch and reset switch.

Indicators

One power on/off LED and three HDD LED.

Dimensions

427(W) x 700(D) x 177(H) mm / 17" x 27.8" x 7"

Operating Temperatures

0~55 °C

Gross Weight

28 kg

Ordering Information

RCK-409B	4U chassis RCK-409 for 14 slot backplane
RCK-409M	4U chassis RCK-409 for ATX motherboard

Contact Information

12F-3 No 77 Shin Tai Wu Road Sec 1
221 Hsi Chi, Taipei Hsien, Taiwan, ROC
Telephone: +886-2-2698-3280 / Fax: +886-2-2698-3304
Sales: sales@aicsys.com / Technical Support: support@aicsys.com